



LSHM-DV SERIES

(0.50 mm) .0197"

HIGH-SPEED HERMAPHRODITIC STRIP

SPECIFICATIONS

For complete specifications and recommended PCB layouts see www.samtec.com?LSHM

Insulator Material:
Black Liquid Crystal Polymer
Contact Material:
Phosphor Bronze
Plating:
Au or Sn over 50 μ" (1.27 μm) Ni
Current Rating:
2.0 A per pin
(2 adjacent pins powered)
Operating Temp Range:
-55 °C to +125 °C
RoHS Compliant:
Yes

Board Mates:
LSHM

Cable Mates:
HLCD

RUGGEDIZED
BY SAMTEC

- High retention contacts
- Audible click when mated
- Shrouded

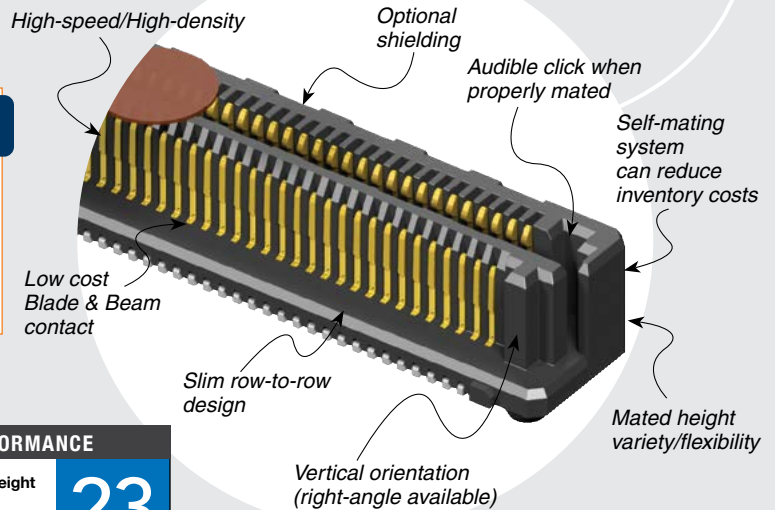

PROCESSING

Lead-Free Solderable:
Yes
SMT Lead Coplanarity:
(0.10 mm) .004" max
Board Stacking:
For applications requiring two or more connectors per board, contact ipg@samtec.com

HIGH-SPEED CHANNEL PERFORMANCE

LSHM-DV/LSHM-DV @ 5 mm Mated Stack Height
Rating based on Samtec reference channel.
For full SI performance data visit [Samtec.com](mailto:SIG@samtec.com) or contact SIG@samtec.com

23
Gbps

RECOGNITIONS

For complete scope of recognitions see www.samtec.com/quality



APPLICATION

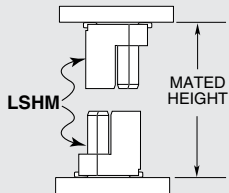

LEAD STYLE	MATED HEIGHT*
-02.5 & -02.5	(5.00) .196
-02.5 & -03.0	(5.50) .217
-03.0 & -03.0	(6.00) .236
-02.5 & -04.0	(6.50) .256
-03.0 & -04.0	(7.00) .276
-04.0 & -04.0	(8.00) .315
-02.5 & -06.0	(8.50) .335
-03.0 & -06.0	(9.00) .354
-04.0 & -06.0	(10.00) .394
-06.0 & -06.0	(12.00) .472

*Processing conditions will affect mated height.

LSHM

1

NO. PINS PER ROW

LEAD STYLE

PLATING OPTION

TAIL OPTION

A

SHIELD OPTION

K

TR

05, 10, 20,
30, 40, 50

Specify LEAD STYLE from chart

-F
= Gold flash on contact, Matte Tin on tail

-L
= 10 μ" (0.25 μm) Gold on contact, Matte Tin on tail

-DV
= Vertical

-S
= With Shield

-N
= Without Shield

-K
= (3.50 mm) .138" DIA Polyimide film Pick & Place Pad

-TR
= Tape & Reel

LEAD STYLE (STANDARD)	LEAD STYLE (LUBRICATED)	A	B
-02.5	-L2.5	(3.95) .156	(1.00) .039
-03.0	-L3.0	(4.45) .175	(1.50) .059
-04.0	-L4.0	(5.45) .215	(2.50) .098
-06.0	-L6.0	(7.45) .293	(4.50) .177

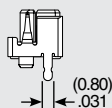
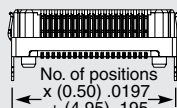
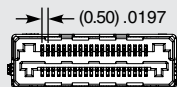

-DV-S

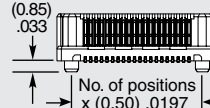
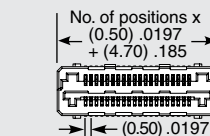

-DV-N

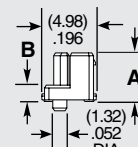

Note: Some lengths, styles and options are non-standard, non-returnable.